

Continuous Perimeter Foundation Vents
Joto-Vent System[®]

**Wildland-Urban Interface
Fire Code Certification**



**ICC-ES ESR-4161 CBC/CRC
SUPPLEMENT / ESL-1274**

The Joto-Vent System 1x6 Joto-Vent “KP-L150U” in conjunction with Architectural Covering “WACF-U45” complies with the performance requirements of ASTM E2886 as described in ESL-1274. According to CBC and CRC, Joto-Vent System may use in the exterior design and construction of new buildings located in a **Fire Hazard Severity Zone** within California State Responsibility Areas or any Wildland-Urban Interface Fire Area. (ICC-ES ESR-4161 CBC/CRC SUPPLEMENT)

Please refer to our ICC-ES Evaluation Report for more information.

<https://icc-es.org/report-listing/esr-4161/>

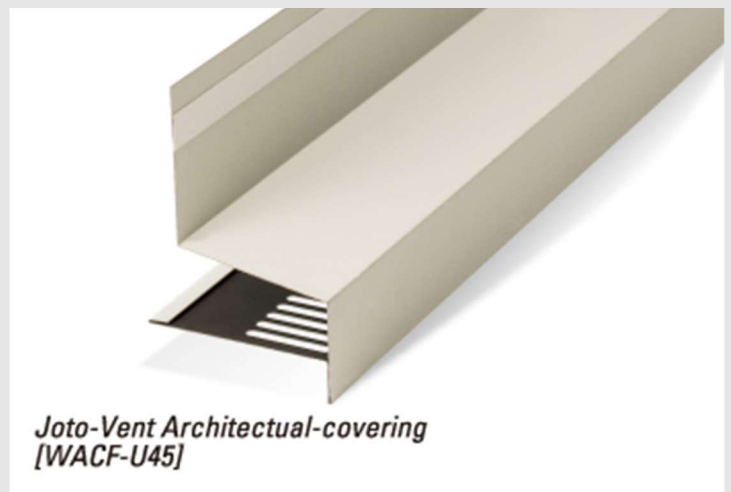
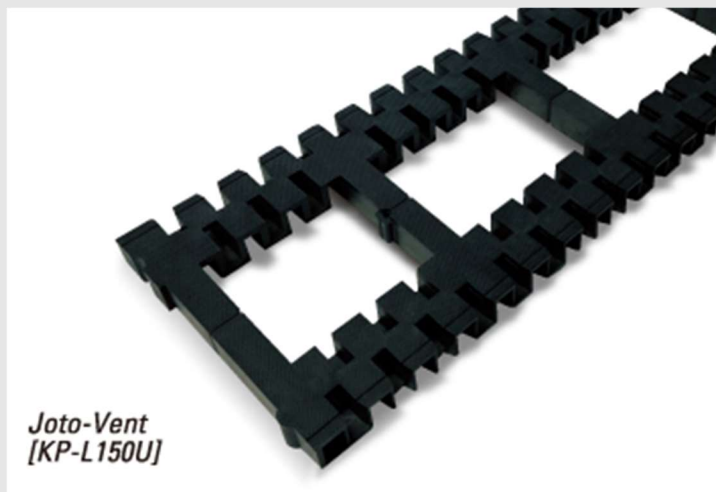
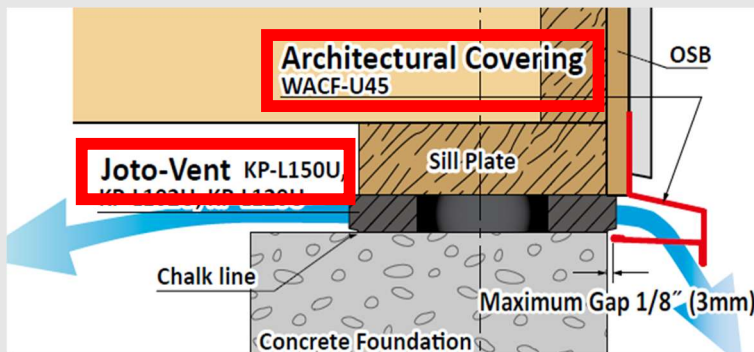

Joto-Vent System[®]
Innovative Building Materials USA, Inc.

Redmond, WA | (425) 256-2210 | info@jotovent.com

Available from
Boise Cascade Woodinville, WA