



Joto-Vent System®

CLEAN LOOK | STRUCTURAL INTEGRITY | NATURAL AIR FLOW

CONTINUOUS PERIMETER FOUNDATION VENTS

WWW.JOTO-VENT.COM

Maintain the life of your home with the Joto-Vent System®

The Joto-Vent perimeter venting system and its covering offer an efficient and low-profile ventilation solution for your crawl space.



Get a Finished, Clean Architectural Look

The 2 part Joto-Vent System® includes the vent portion and the custom coverings that are installed over the vent, resulting in a clean visual look.



Support Natural Air Flow & Ventilation

Installed around the complete perimeter of the crawl space foundation, the Joto-Vent System® maximizes cross ventilation and natural air flow, preserving the lifespan of your home's wooden frame.



Maintain Your Home's Structural Integrity

The Joto-Vent System® eliminates the need for vent holes installed in the concrete foundation or cut into the structural framework of the rim joist maximizing the strength & performance of your home's structure.



Stanwood, WA

Joto-Vent System



Port Townsend, WA

Joto-Vent System



The Joto-Vent is made of "JC (Joto-Compound)", a composite material that consists of calcium carbonate, polyolefin resin and recycled plastics.

JC was awarded manufacturing patents in the United States and several European countries as a recycled resin heat treatment system called "Joto-process".

Joto-Vent has an ultimate compression strength of over 56,000 pounds per lineal foot of Joto-Vent, and when you apply ICC-ES you can safely support 7,140 pounds per lineal foot of Joto-Vent. Wherever you trust a wooden sill plate, you can trust The Joto-Vent System.



2 x 6 Joto-Vent System[®]

NFVA: 11.03 in²/ft

ICC
ES

Crawl Space

Option 1

2 x 6 Joto-Vent

ICC
ES

Option 2

Architectural-covering

ICC
ES

(Optional) Z-Covering

The Z-Covering is a galvanized steel plate conforming to ASTM A792 called "galvalume". With a 1-inch protrusion, it can maximize the ventilation performance of the 2x6 Joto-Vent.

Insect Prevention Strip

ICC
ES

The Joto-Vent Insect Prevention Strip is a galvanized steel plate conforming to ASTM A792 called "galvalume". It has a minimum opening of 1/8 inch, which provides efficient underfloor ventilation while also providing an insect prevention. By combining with Z-Covering with smaller protruding dimensions (sold separately), it can minimize the impact on the aesthetic appearance while preventing deterioration of the bottom edge of the siding. This Insect Prevention Strip is ICC-ES approved.

The primary component of the Joto-Vent is a molded calcium carbonate and polyolefin resin composite. The Joto-Vent is placed between the concrete foundation wall and the wooden sill plate to provide natural airflow around and through the entire perimeter of the crawl space. The Net-Free Ventilation Area (NFVA) is 11.03 in²/ft. When installing, leave at least 1 inch of clearance between the foundation and the siding or the back of covering to avoid blocking underfloor ventilation.

By cutting this product and placing it sideways, it can prevent the cross-bending issues of the sill plate that may occur in the dropped floor application. By placing it into the space for the anchor bolts, it will also function as the Reinforcement-block against vertical load. (Contact us for details or our supporting letter for engineers.)

One of the components required for the Joto-Vent System[®]. The Joto-Vent Architectural Covering is a galvanized steel plate conforming to ASTM A792 called "galvalume". It acts as the cover for the Joto-Vent and the seat for the exterior wall sheathing. By installing it to the bottom edge of the wall, it acts as a drip edge to prevent deterioration of the siding. The slat opening on the back side plays a role as an insect prevention, the minimum opening is 1/8 inch, and it is approved by ICC-ES.



Z-Covering
[EAC-0-10]



Insect Prevention Strip
[JIP-2-10]



2x6 Joto-Vent
[JVS-26CV]

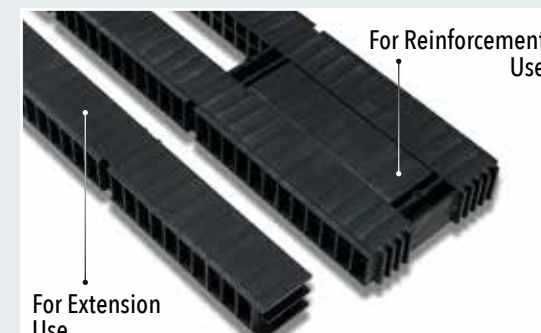

For Extension Use

For Reinforcement Use



Architectural-covering
[JAC-2-10]

2 x 6 Joto-Vent (Net-Free Ventilation Area (NFVA): 11.03 in²/ft)

JVS-26CV

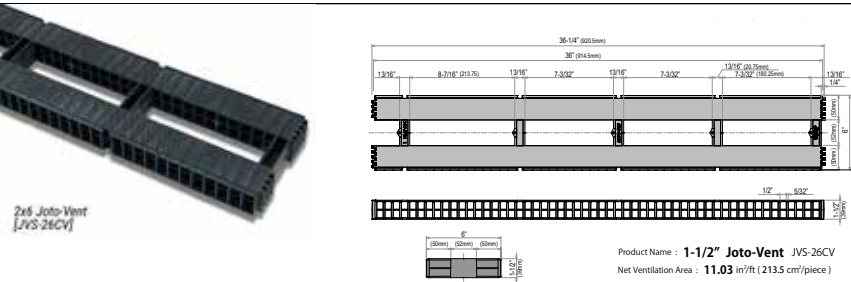

| | |
|-----------------------|---|
| Product no. | JVS-26CV |
| Sill plate | 2 x 6, 2 x 8 |
| Color/pattern | Black |
| Dimensions | 6" x 3" x 1-1/2" (150 x 914.5 x 39mm) |
| Material | JC |
| Operation temperature | -22 °F to +104 °F (-30 °C to +40 °C) |
| Package | 8 pieces/box |

TECHNICAL SPECIFICATION

- Peak compression load for Joto-Vent JVS-26CV:
Approx. 114000 lb/piece (38000 plf*)
- ICC-ES approved maximum allowable compression load for Joto-Vent JVS-26CV:
4180 plf*
*plf = pounds per linear foot
- See our ICC-ES reports for more details.

Insect Prevention Strip

JIP-2-10

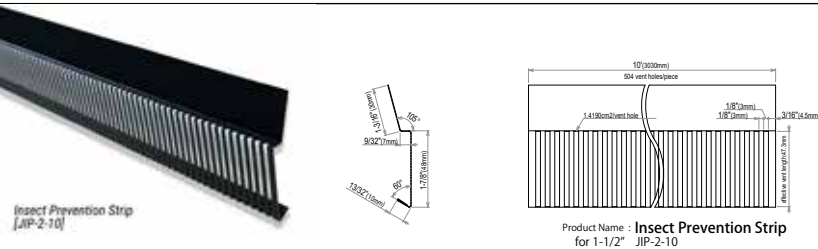

| | |
|--------------------------|---|
| Product no. | JIP-2-10 |
| Dimensions | 10" (3,030mm) |
| Color | Black |
| Material | 28-gauge galvanized steel (colored galvalume) |
| Package | 10 pieces/box |
| Min. ventilation opening | 1/8 inch |

(Optional) Z-Covering

EAC-0-10

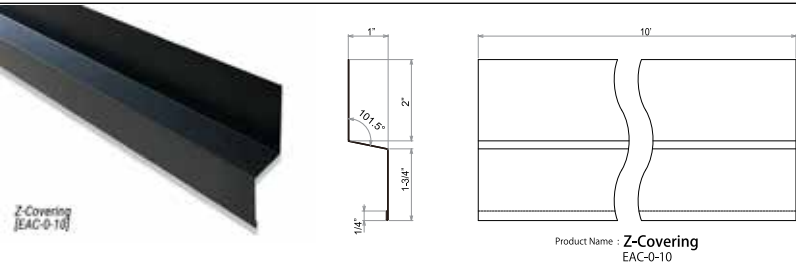

| | |
|-------------|---|
| Product no. | EAC-0-10-BK |
| Dimensions | 10" (3,030mm) |
| Color | Black |
| Material | 28-gauge galvanized steel (colored galvalume) |
| Package | 10 pieces/box |

Accessories for EAC-0-10

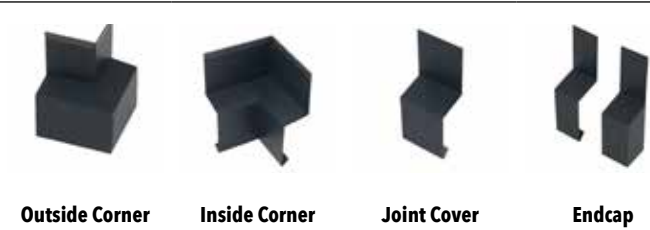

| | Product No | Package |
|----------------|-------------|---------------|
| Outside corner | EAC-0-CO-BK | 5 pieces/box |
| Inside corner | EAC-0-CI-BK | 5 pieces/box |
| Joint cover | EAC-0-JC-BK | 20 pieces/box |
| Endcap | EAC-0-EC-BK | 5 sets/box |

Architectural-covering

JAC-2-10

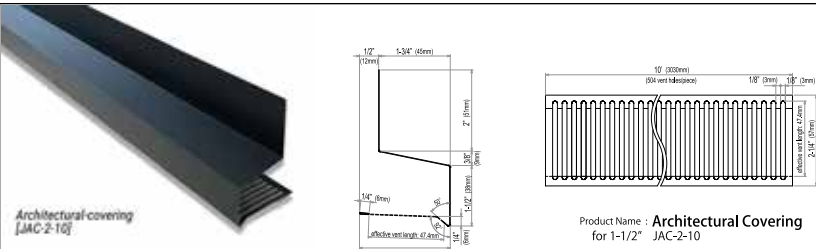

| | |
|--------------------------|---|
| Product no. | JAC-2-10-BK |
| Dimensions | 10" (3,030mm) |
| Color | Black |
| Material | 28-gauge galvanized steel (colored galvalume) |
| Package | 10 pieces/box |
| Min. ventilation opening | 1/8 inch |

Accessories

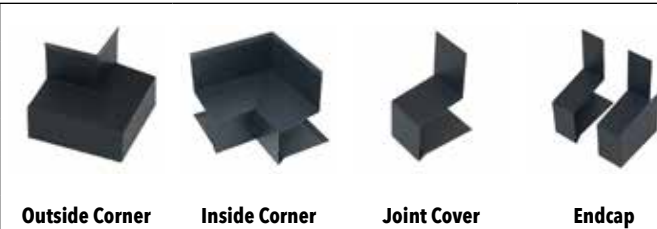

| | Product No | Package |
|----------------|-------------|---------------|
| Outside corner | JAC-2-CO-BK | 5 pieces/box |
| Inside corner | JAC-2-CI-BK | 5 pieces/box |
| Joint cover | JAC-2-JC-BK | 20 pieces/box |
| Endcap | JAC-2-EC-BK | 5 sets/box |

Installation Diagram

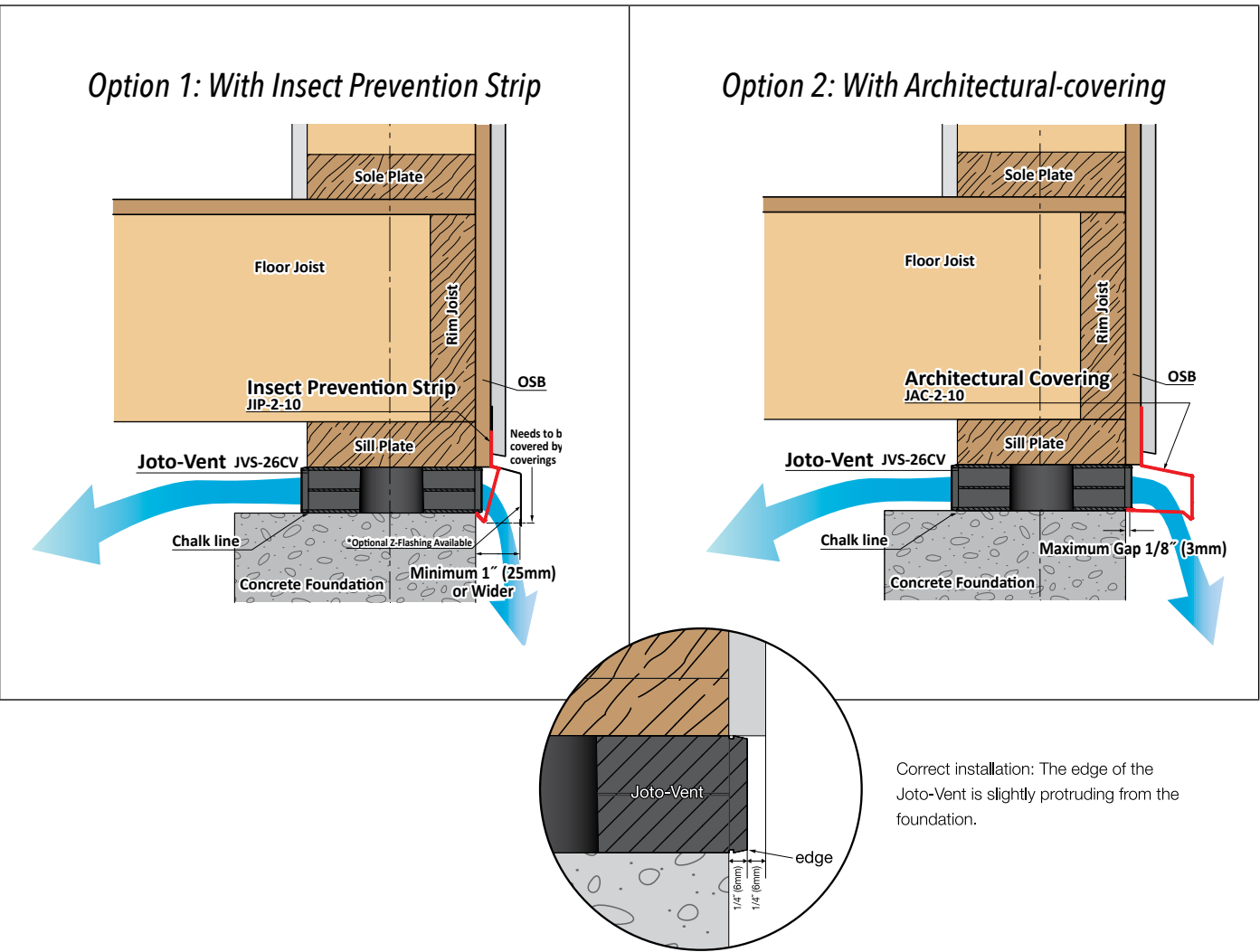

1 x 6 Joto-Vent System®

NFVA: 4.81 in²/ft

ICC
ES

Crawl Space

Slab
(Garage)

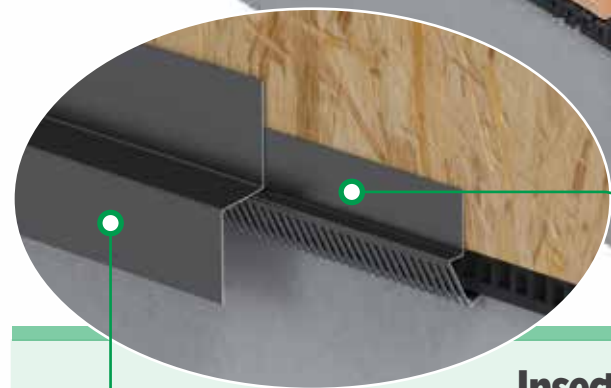

Option 1

(Optional) Z-Covering

The Z-Covering is a galvanized steel plate conforming to ASTM A792 called "galvalume". With a 1-inch protrusion, it can minimize the impact on the aesthetic appearance.



Insect Prevention Strip

The Joto-Vent Insect Prevention Strip is a galvanized steel plate conforming to ASTM A792 called "galvalume". It has a minimum opening of 1/8 inch, which provides efficient underfloor ventilation while also providing an insect prevention. By combining with Z-Covering with smaller protruding dimensions (sold separately), it can minimize the impact on the aesthetic appearance while preventing deterioration of the bottom edge of the siding. This Insect Prevention Strip is ICC-ES approved.



1 x 6 Joto-Vent

The primary component of the Joto-Vent is a molded calcium carbonate and polyolefin resin composite. The Joto-Vent is placed between the concrete foundation wall and the wooden sill plate to provide natural airflow around and through the entire perimeter of the crawl space. The Net-Free Ventilation Area (NFVA) is 4.81 in²/ft. When installing, leave at least 1/2 inch of clearance between the foundation and the siding or the back of covering to avoid blocking underfloor ventilation.



(Optional) Reinforcement-block

The primary use is to provide more reinforcement against the compression point at the foundation where a heavy vertical load from a post is applied. Consult with a structural engineer for advice on how best to use the block.



Airtight Joto-Vent

The KPK-N140U Airtight Joto-Vent is our improved design of the Joto-Vent Air-blocking. It is used to create an air barrier between the garage and crawlspace and also can be used for slab on grade and entry areas. Use of the Airtight Joto-Vent allows for continuous use of the Joto-Vent and consistent height around the entire perimeter of the foundation when used with the Joto-Vent. EPDM Foam strips and connectors on each end have been added to create an even tighter seal.



Option 2

Architectural-covering

One of the components required for the Joto-Vent System®. The Joto-Vent Architectural Covering is a galvanized steel plate conforming to ASTM A792 called "galvalume". It acts as the cover for the Joto-Vent and the seat for the exterior wall sheathing. By installing it to the bottom edge of the wall, it acts as a drip edge to prevent deterioration of the siding. The slat opening on the back side plays a role as an insect prevention, the minimum opening is 1/8 inch, and it is approved by ICC-ES.



1 x 6 Joto-Vent (Net-Free Ventilation Area (NFVA): 4.81 in²/ft)

KP-L150U

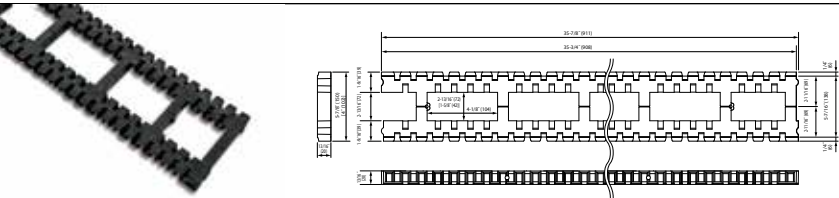

TECHNICAL SPECIFICATION

- **Ultimate compression load for Joto-Vent KP-L150U:**
Approx. 168000 lb/piece (56000 plf*)
- **ICC-ES approved maximum allowable compression load for Joto-Vent KP-L150U:**
7140 plf*
- **See our ICC-ES reports for details.**
- *plf = pounds per linear foot

| | |
|---------------|-----------------------------------|
| Product no. | KP-L150U |
| Sill plate | 2 x 6, 2 x 8 |
| Color/pattern | Black |
| Dimensions | 6" x 3' x 3/4" (150 x 908 x 20mm) |
| Material | JC |
| Package | 20 pieces/box |

(Optional) Airtight Joto-Vent

KPK-N140U

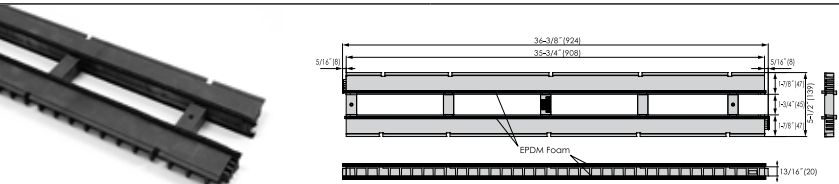

TECHNICAL SPECIFICATION

- **Ultimate compression load for Airtight KPK-N140U:**
Approx. 69060 plf*
- **ICC-ES approved maximum allowed compression load for Airtight KPK-N140U:**
8703 plf*
- **See our ICC-ES reports for details**
- *plf = pounds per linear foot

| | |
|---------------|---|
| Product no. | KPK-N140U |
| Sill plate | 2 x 6 |
| Color/pattern | Black |
| Dimensions | 5-1/2" x 3' x 3/4" (140 x 908 x 20mm) |
| Material | JC, EPDM Foam |
| Package | 16 pieces/box (2 EPDM Foam Pads included) |

(Optional) Reinforcement-block

KP-LRB150

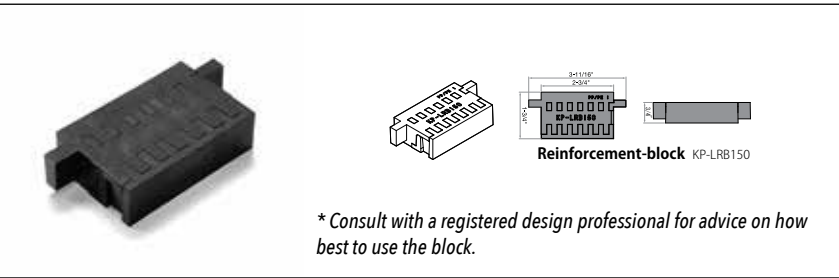

* Consult with a registered design professional for advice on how best to use the block.

| | |
|--------------------------|---|
| Product no. | KP-LRB150 Designed for use with KP-L150U |
| Color/pattern | Black |
| Dimensions | 3-11/16" x 1-3/4" x 3/4" |
| Material | JC |
| Package | 50 pieces/box |
| Allowable load per block | 5,470 lbs* |

(Optional) Joto-Vent Extension Strip

KP-L60UH

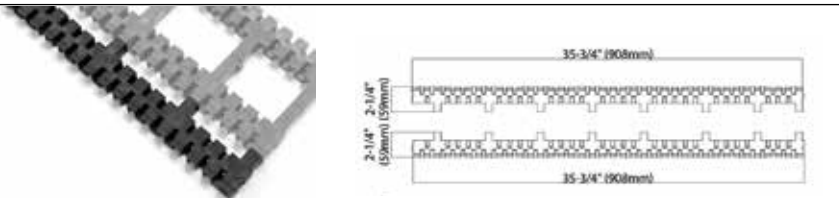

| | |
|---------------|--------------------------------------|
| Product no. | KP-L60UH |
| Color/pattern | Black |
| Dimensions | 2-1/4" x 3' x 3/4" (59 x 908 x 20mm) |
| Material | JC |
| Package | 20 pieces/box |

* The KP-L60UH Extension Strip is an optional accessory to be used with the KP-L150U to provide additional support on the interior side of 8" foundations using a 2x10 sill plate. This product is not currently certified or meant to be used as a structural member.

Architectural-covering

WACF-U45 (Net-Free Ventilation Area (NFVA): 5.73 in²/ft (121 cm²/m))

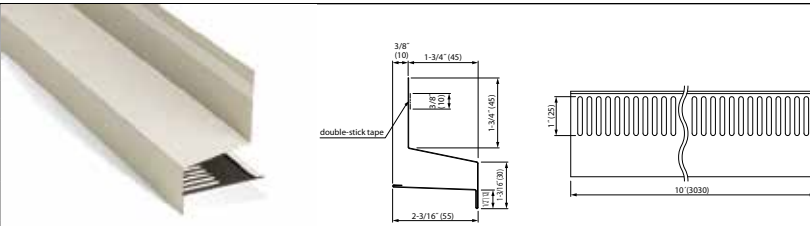

| | |
|-------------------------|---|
| Product no. | WACF-U45-WT/BK |
| Dimensions | 1-3/4" x 10' (45 x 3030mm) |
| Color | White/Black |
| Material | 28-gauge galvanized steel (colored galvalume) |
| Package | 10 pieces/box |
| Min ventilation opening | 1/8 inch |

Accessories for WACF-U45

| | Product No | Package |
|-----------------|------------------|-------------------------------|
| Outside corner | WACF-U45CO-WT/BK | 5 pieces/box |
| Inside corner | WACF-U45CI-WT/BK | 5 pieces/box |
| Joint cover | WACF-U45JC-WT/BK | 20 pieces/box |
| Endcap | WACF-U45EC-WT/BK | 5 sets/box |
| Vertical corner | Right | WACF-U45VCR-WT/BK 10 sets/box |
| | Left | WACF-U45VCL-WT/BK 10 sets/box |

Insect Prevention Strip

KIP-1-10

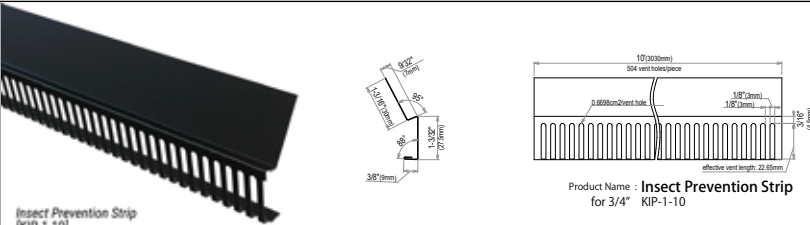

| | |
|--------------------------|---|
| Product no. | KIP-1-10 |
| Dimensions | 10' (3,030mm) |
| Color | Black |
| Material | 28-gauge galvanized steel (colored galvalume) |
| Package | 10 pieces/box |
| Min. ventilation opening | 1/8 inch |

(Optional) Z-Covering

EAC-0-10

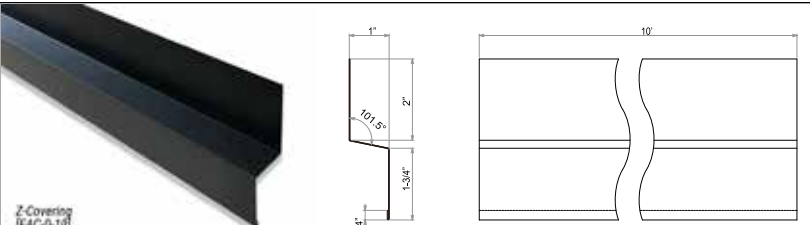

| | |
|-------------|---|
| Product no. | EAC-0-10-BK |
| Dimensions | 10' (3,030mm) |
| Color | Black |
| Material | 28-gauge galvanized steel (colored galvalume) |
| Package | 10 pieces/box |

Accessories for EAC-0-10

| | Product No | Package |
|----------------|-------------|---------------|
| Outside corner | EAC-0-CO-BK | 5 pieces/box |
| Inside corner | EAC-0-CI-BK | 5 pieces/box |
| Joint cover | EAC-0-JC-BK | 20 pieces/box |
| Endcap | EAC-0-EC-BK | 5 sets/box |

Installation Diagram

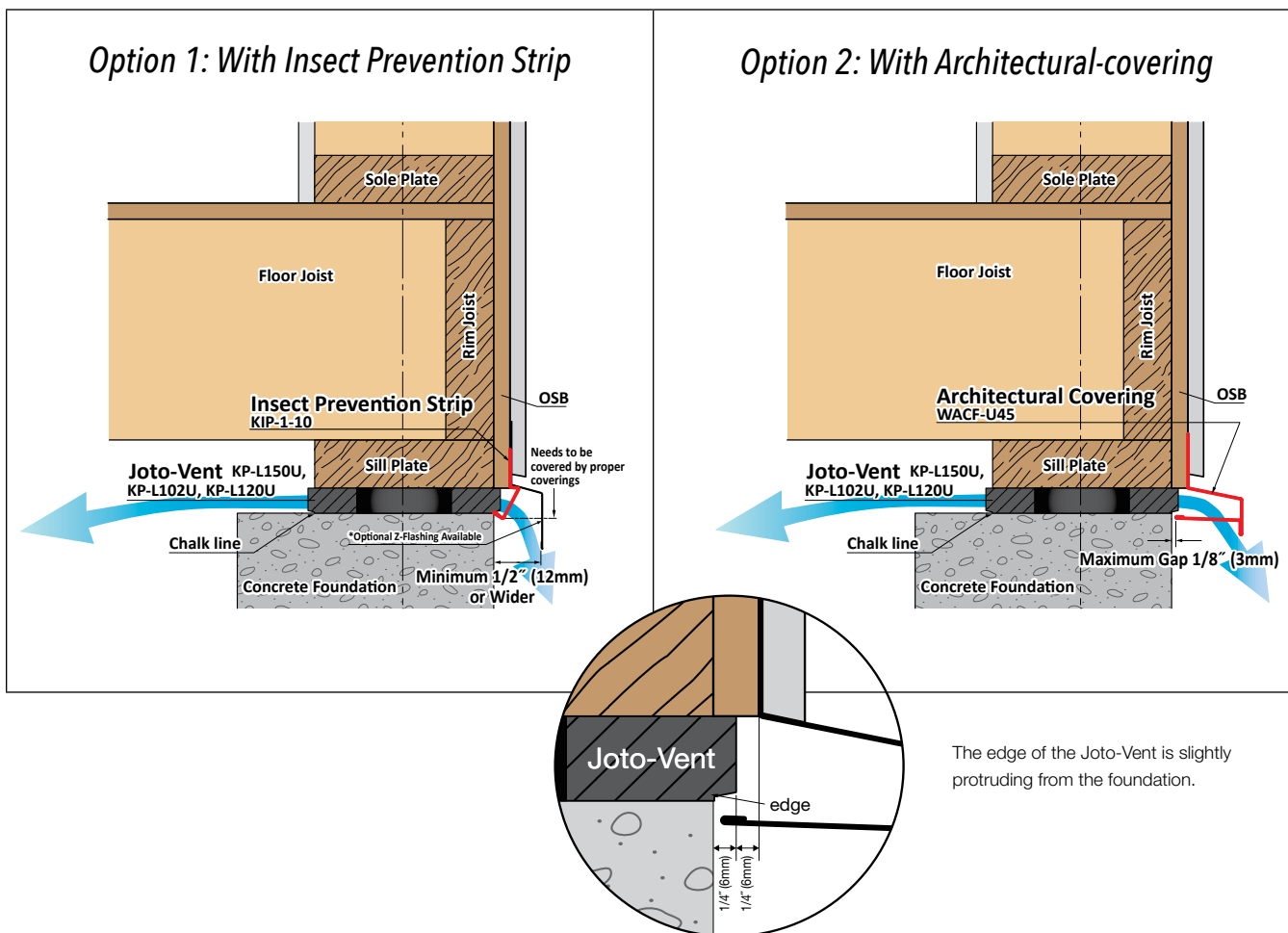

Reference diagrams for dropped floor applications

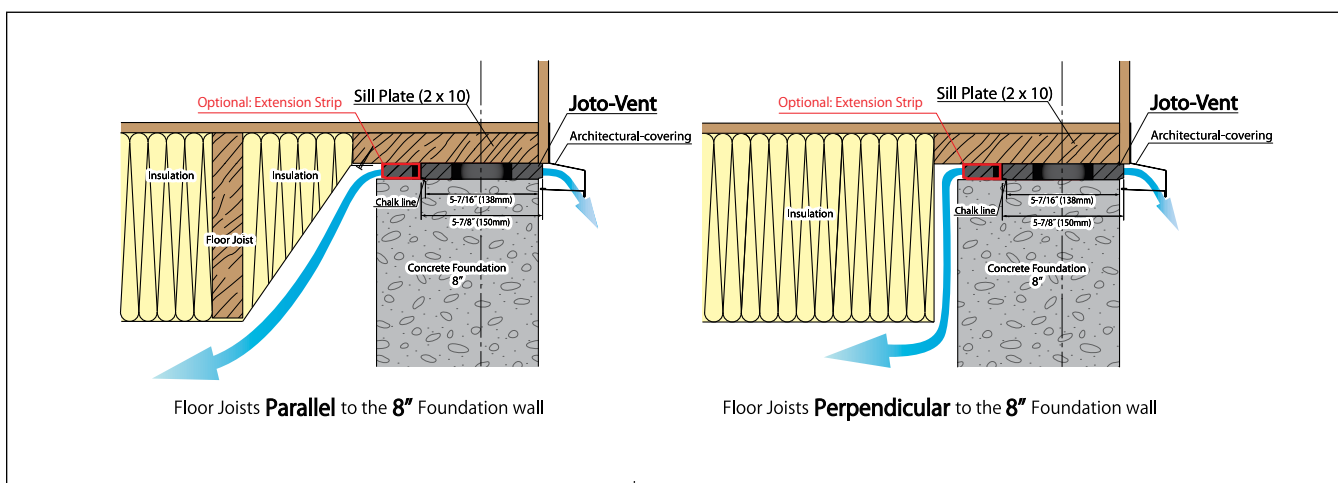

US SALES OFFICE OF JOTO TECHNO CO., LTD.



Joto-Vent System®
Innovative Building Materials USA, Inc.

17530 NE Union Hill Rd Suite 240
Redmond, WA 98052
Tel: 425-256-2210
Fax: 425-522-4804
Online: joto-vent.com
Email: info@jotovent.com

2022.10

