

Accessories

**Vertical-corner:** install by using stainless-steel nails as shown in the illustrations.

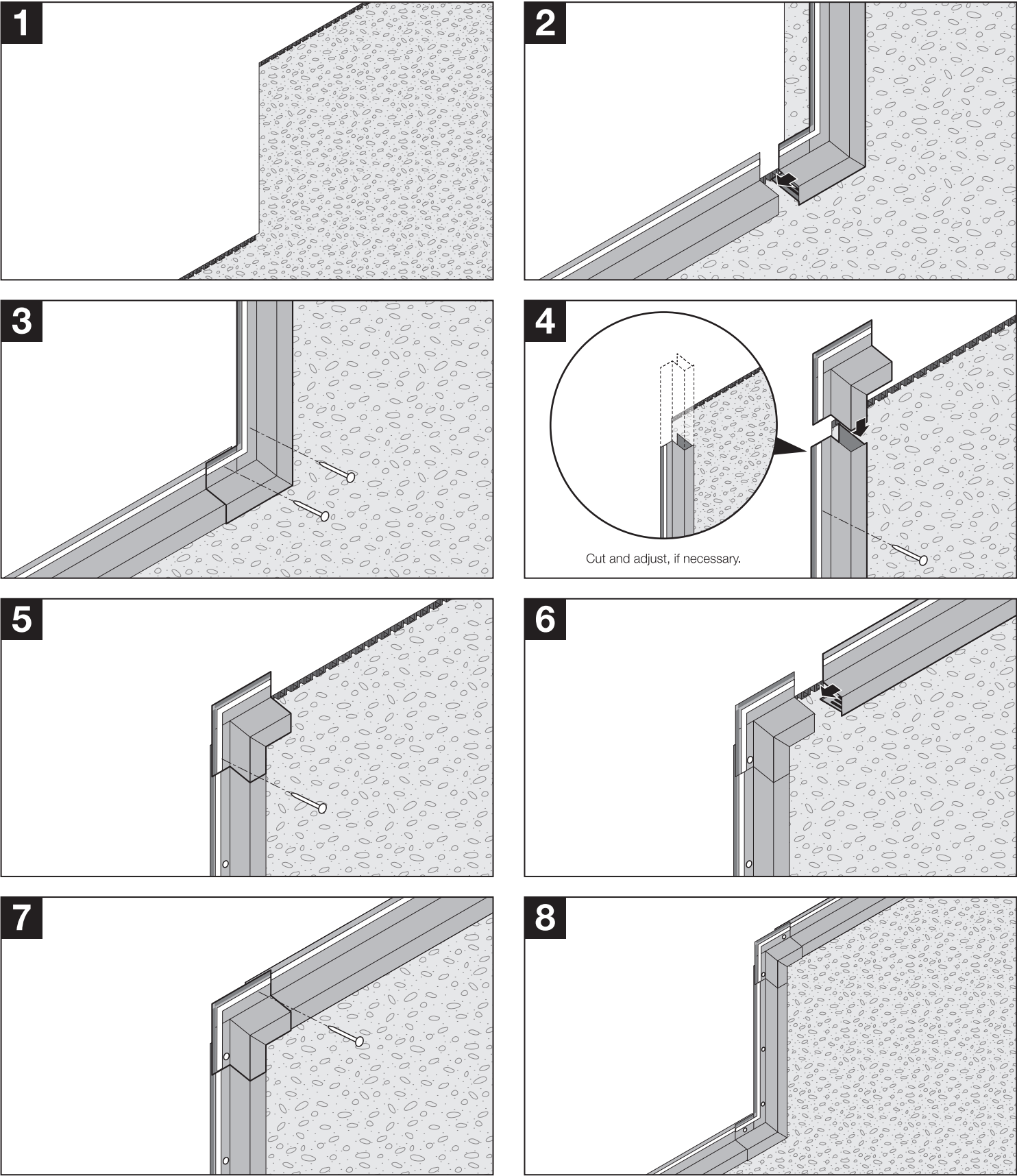

Exclusive Distributor: **Interra USA,Inc.**  
Location: 981 Powell Ave SW #115 Renton, WA 98057 USA  
Tel: 425-277-7850 Fax: 425-277-7410

**JOTO TECHNO Co.,Ltd.**

**Joto**

28 guage Galvanized Steel

**Installation Manual**  
for Joto-Vent Architectural-covering

Joto-Vent System  
Foundation Vent System



UES Report Number  
**ER #346**  
Inspection by RI Ogawa & Associates,Inc.(AA-705)

\*Before installing the products, read this Installation Manual carefully in order to install them properly.

Table of Joto-Vent Architectural-covering members

Packing contents		
Product No.	Remarks	Package
WACF-U45	Main body 10 ft. in length	10pieces/box
WACF-U45CO	Outside-corner	5pieces/box
WACF-U45CI	Inside-corner	5pieces/box
WACF-U45JC	Joint-cover	20pieces/box
WACF-U45EC	Endcap	5sets/box
WACF-U45VC (R/L)	Vertical-corner (Right/Left)	10sets/box

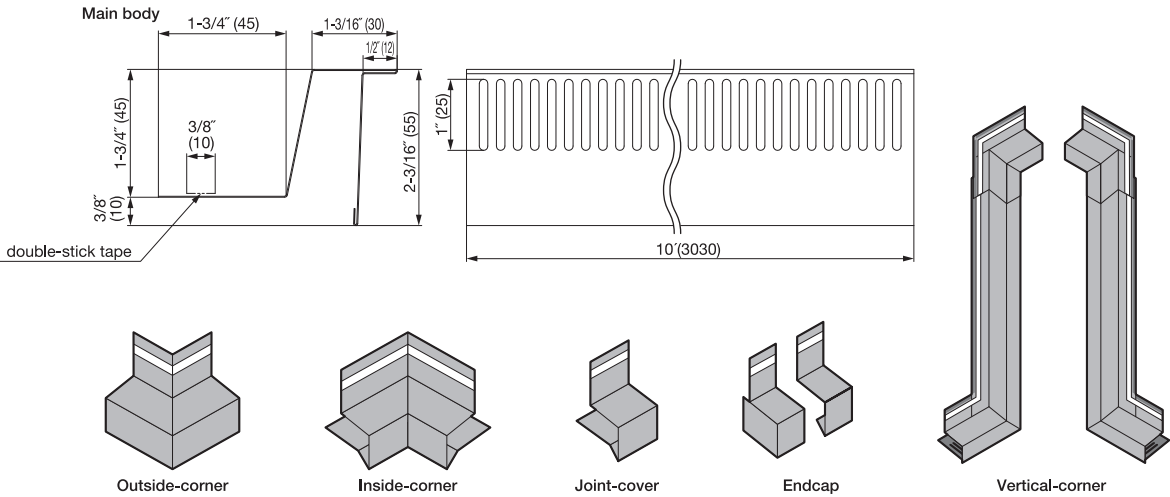

**JOTO TECHNO Co.,Ltd.**

Installation procedures

Install the Architectural-covering per the following instructions and illustrations.

WARNING

- Wear appropriate protective gear such as gloves, hard hats, and protective glasses while at work. Use appropriate cutting tools. Never use inappropriate tools for cutting purpose such as sander to cut by friction. Properly handle the tools per their manufacturers' operations manual.
- Provide necessary personnel and equipment to ensure safety transportation of the products. In particular, lengthy items must be carried by an appropriate number of people. If it must be carried by one person, keep it in balance by holding at the center point. Not doing so may lead to personal injury or property damages.
- Do not throw or drop the products. Do not step on the products or put anything on them. Doing so may lead to personal injury or property damages.
- Be careful about sharp corners and edges of the products. In particular, be careful not to cut your hand or other body parts with a sharp edge of the products once it has been cut to length.
- Never burn, eat, or let children play with the products. Doing so may lead to serious accidents.

CAUTION

- Avoid storage under very high or very low temperatures. Do not store the products outdoors. Do not keep the products upright. Doing so may lead to deformation of the products.
- Store the products on a flat surface.
- Never draw out the products from a small opening of a package. Doing so may damage the products.
- Do not block the ventilating holes when you paint the products. Doing so may impair the ventilation performance.
- Avoid using in contact with chemical-treated woods, CCA containing copper, lead, etc. and fire-retardant timbers when using the products, as there is a chance of corrosion when in contact with these types of treated woods. Also, avoid joining the products with fittings or accessories using dissimilar metals such as copper, lead, and alloys.
- Do not use the products at coastal areas (potential damage by seawater) or dense fog-prone areas. This product is a painted galvanized steel, however extreme salty costal air can cause corrosion.
- Drip water caused by exhaust fumes from car or chimney may peel off the paint and coating.
- Remove the plastic film protective sheets on the overlap space of joint before installation.

NOTICE

Use stainless-steel nails to install the Architectural-covering.  
Remove the plastic film protective sheets on the Architectural-covering immediately after installation.

Combination of Joto-Vent and Architectural-covering

Install the Architectural-covering by using stainless-steel nails, at an interval of 1.5 ft., over OSB or plywood (outside). The installation should be made at the position where the top of the Architectural-covering comes at 1-3/4 inch (45 mm) above the top surface of the Joto-Vent.

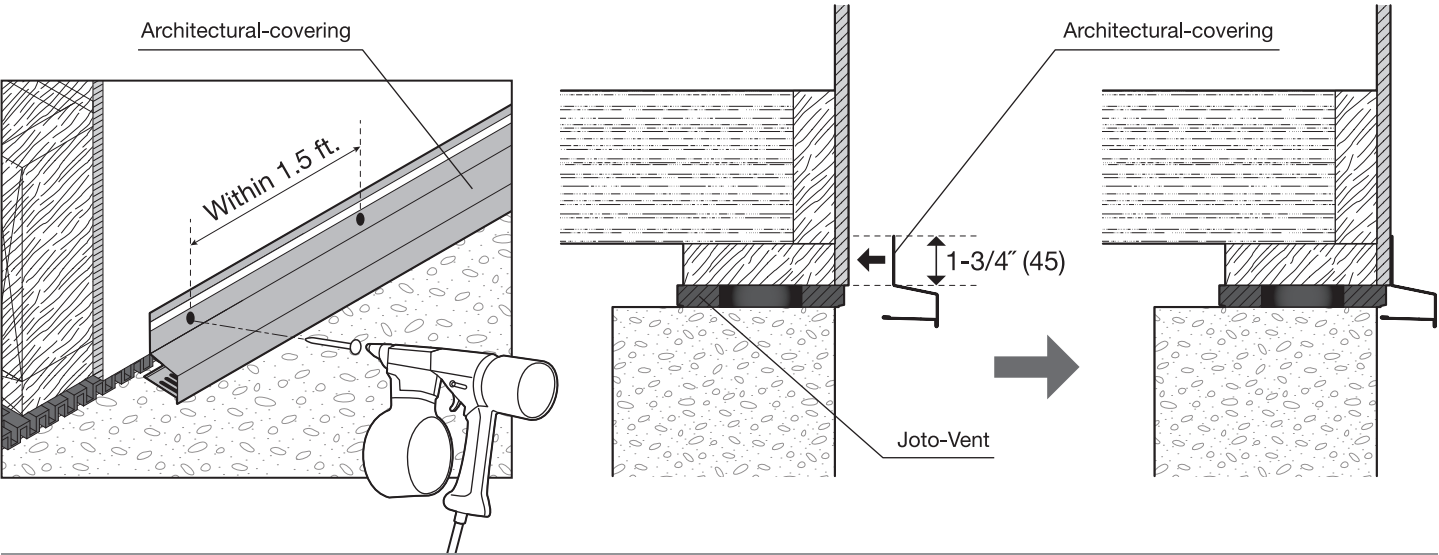

NOTICE

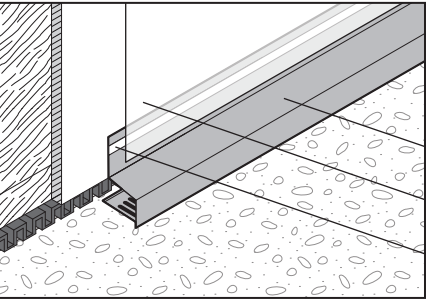

Securely fix the lower end of the house wrap to the Architectural-covering with the double-stick tape attached to the Architectural-covering main body.

Architectural-covering  
House Wrap  
Double-stick tape

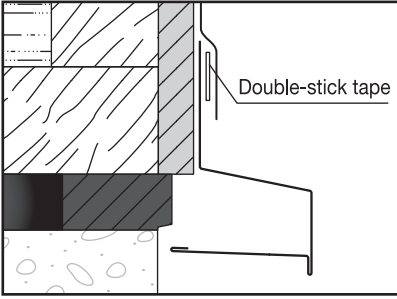

Double-stick tape

Accessories

Optional materials must be selected from our specified products.  
Refer to CAUTION and NOTICE for handling precautions.

**Outside-corner:** install by using stainless-steel nails as shown in the illustrations.

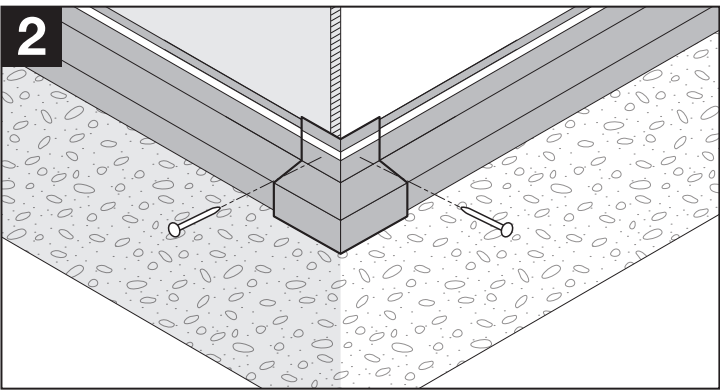
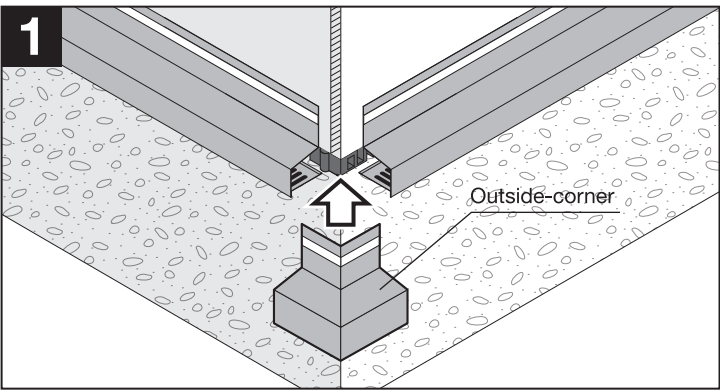

**Inside-corner:** install by using stainless-steel nails as shown in the illustrations.

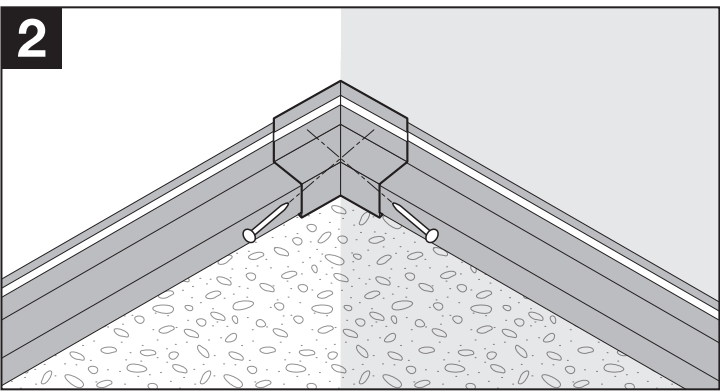
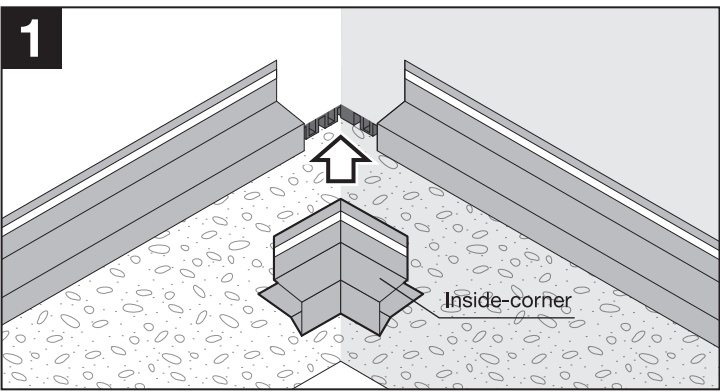

**Joint-cover:** install by using stainless-steel nails as shown in the illustrations.

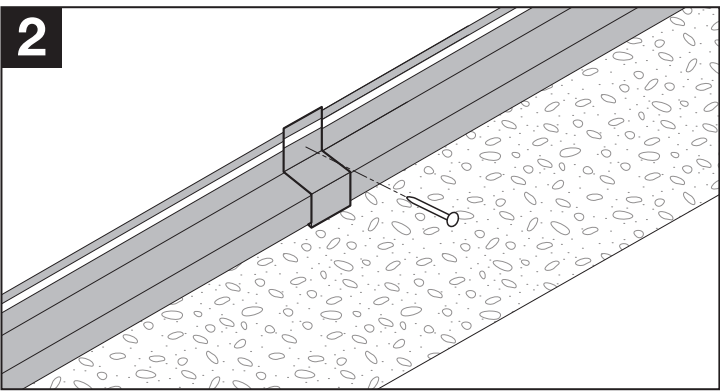
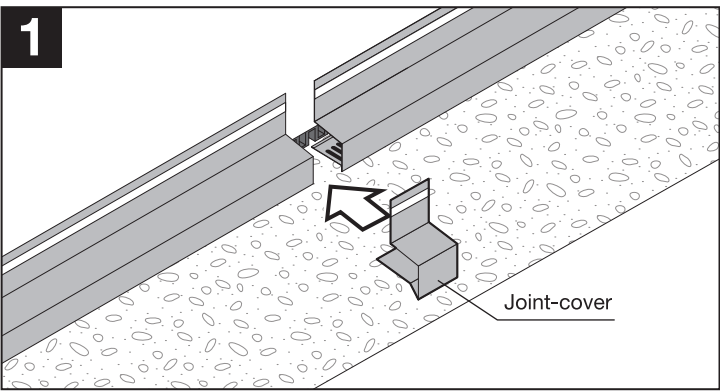

**Endcap:** install by using stainless-steel nails as shown in the illustrations.

